

## AIR MAKE-UP UNITS

Product Line Overview & Capabilities



JULY 2019

## Customized Solutions

### Unmatched Flexibility



As one of the most sophisticated manufacturers of Air Make-Up Units, Aerovent's unique ability to customize our products for the exact application is second to none. By leveraging our comprehensive product offerings and 3D modeling technology, Aerovent has the knowledge and engineering expertise to provide customized solutions for our customers' project-specific needs.



When you partner with Aerovent, not only do you get the product flexibility you require, you also get the highest quality products and construction features to meet your precise specifications. And with a wider range of sizes, custom components and specialized coatings, we can provide more options and controllability than any manufacturer.



### Validation

- UL 508 Electrical Control Panel Certification
- ANSI Z83.4 Construction
- ETL Listing
  - Z83.4 – 100% Outside Air
- NEMA 12 Control Enclosures and NEC Oil tight Wiring Standards
- AMCA 210 Fan and Blower Performance Tested in accordance with AMCA 210 Procedures
- FM & IRI Insurance Standards as required

### Laboratory/Field Testing & Startup Services

- Sound & Air Performance Testing
- Vibration Testing
- Seismic Testing (test lab only)
- Equipment Commissioning



### Controllability

- Factory installed controls are available with a wide range of options and can be customized to interface with automated building management systems

### Customer Drawings

- Customer drawings are available in 3D, 2D and Revit files formats



## Industries Served

- > Automotive
- > Paper & Pulp
- > Power Generation
- > Food Processing
- > Chemical Processing
- > Wastewater & Sewage
- > Manufacturing
- > Foundries
- > Pharmaceutical
- > Textile
- > Warehousing
- > Mining
- > Transit Stations
- > Steel Mills
- > Marine

## Typical Applications

- > Heating
- > Cooling
- > Humidifying
- > Air Filtration / Fresh Air Supply
- > Air Turnover
- > Door Air Heaters
- > Process Heating or Cooling
- > Product Dryers
- > Paint Finishing Systems

**AEROVENT**   
INDUSTRIAL VENTILATION SYSTEMS



### Heating

- > Direct-Fired Gas
- > Direct-Fired Gas with 80/20 Recirculation
- > Indirect-Fired Gas
- > Modulating
- > Face & Bypass
- > Integral Face & Bypass
- > Modulating Electric Heat

### Cooling

- > Air Cooler Media Type
- > Chilled Water
- > Direct Expansion – Refrigerant

### Humidification

- > Mist Spray Humidification
- > Steam Humidification

### Filters

- > Pleated Filters
- > Metal Filters
- > Bag Filters
- > Cartridge Filters
- > HEPA Filters
- > Available in a Wide Range of Efficiencies

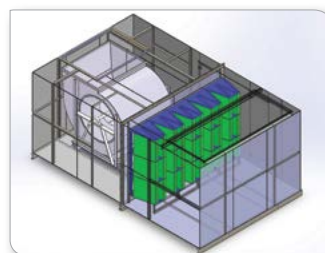
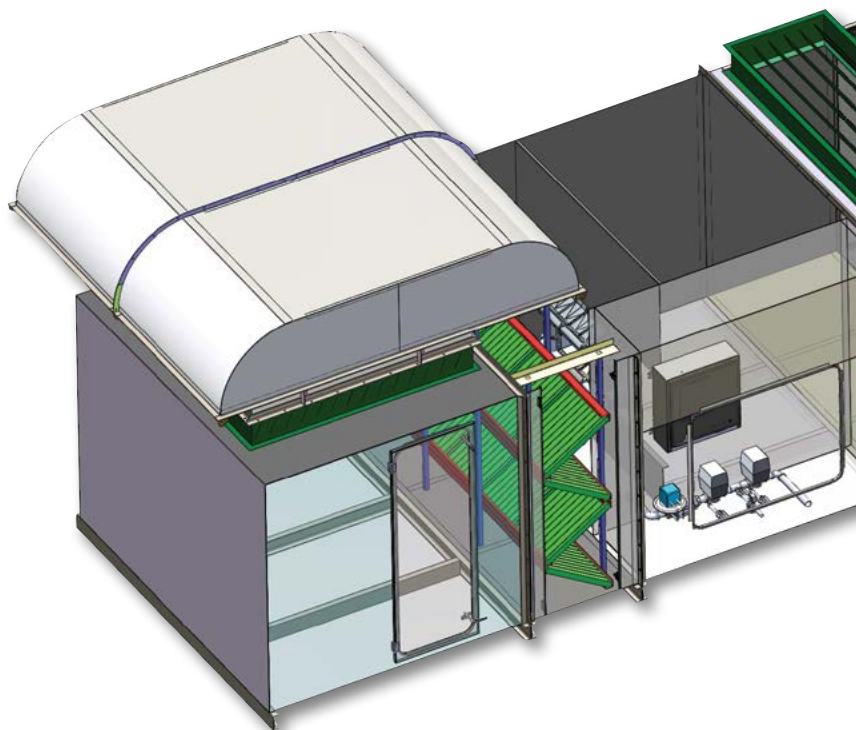

V-Bank Carbon Filters



Motor Removal Rail



Direct-Fired Gas Heat



Velocity Meter

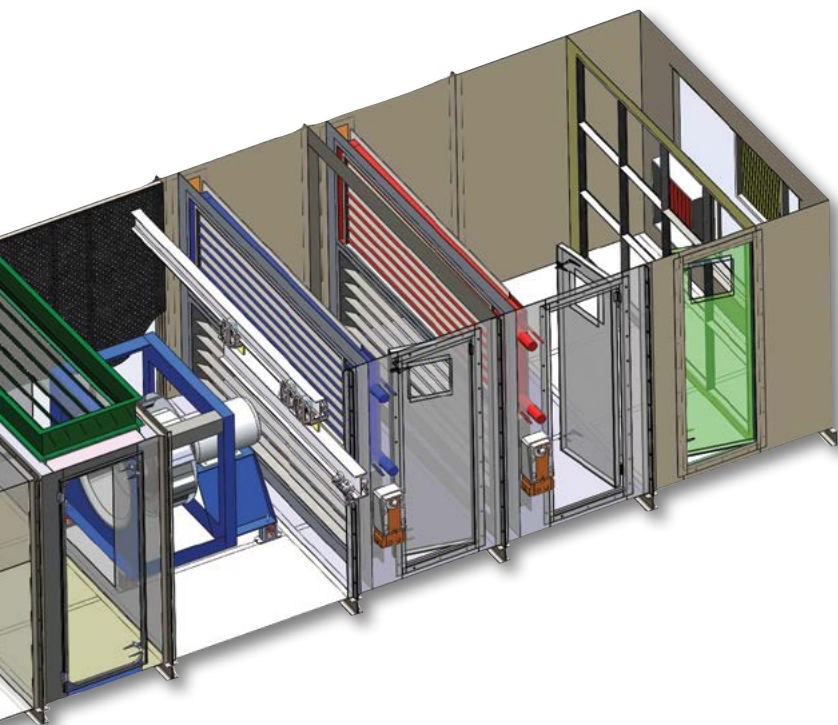

## Configurations

- > Top Horizontal
- > Bottom Horizontal
- > Upblast
- > Downblast
- > Vertical Air Flow Up
- > Vertical Air Flow Down
- > Rooftop Mounted (with Curb)
- > Rooftop Mounted (without Curb)
- > Outdoor Pad Mounted
- > Indoor Mounted

## Controllers

### Stand Alone Controls

- > Outlet Temperature Control (OTC)
- > Modulating Room Temperature Control (MRTC)

### Direct Digital Control (DDC) Systems

- > DDC Compatible – Take Control of Equipment with Existing DDC System

## Fan Types

- > Centrifugal SWSI
- > Centrifugal DWDI
- > Axial
- > Plenum
- > Spark Resistant

## Construction

- > Painted Mild Steel
- > Stainless Steel
- > Galvanized
- > Aluminum
- > Full Welded or Bolted



FM or IRI Pipe Train



Discharge Sensor



Tamper-Proof Control Station

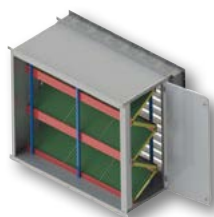

V-Bank Filter Section



Direct-Fired Gas Heat

## Industrial Direct-Fired Gas

### Model BIBT

Direct-fired gas air make-up units are a complete air supply system in a self-contained package with fan, burner and controls. The units are ready for connection to the gas line and power source. These systems are for use in industrial or commercial applications where supplying tempered outside air is required.

#### Standard Construction

- Heavy-duty backward inclined DWDI centrifugal blower
- 14-gauge welded steel housing
- Peaked roof to eliminate standing water
- 0 to 92 degree temperature rise
- Dual fuel burner
- Factory assembled and tested
- Remote operating station

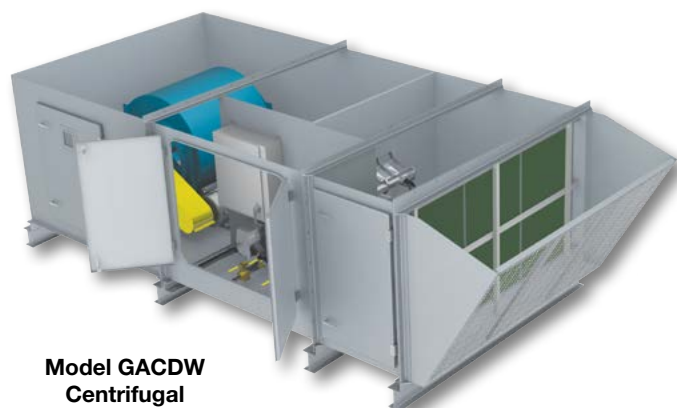

Model GACDW  
Centrifugal

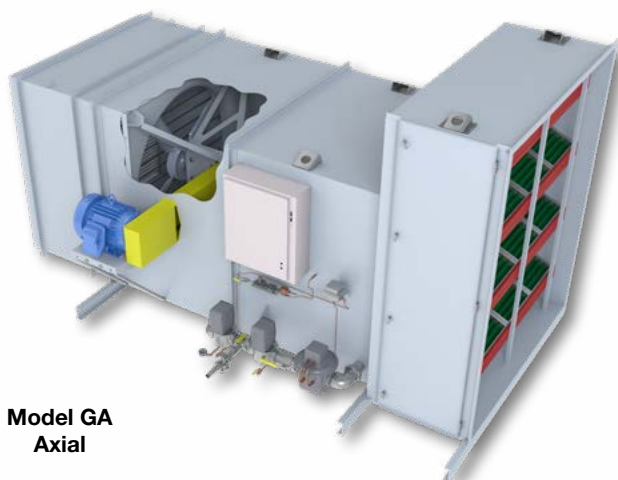

Model GA  
Axial

## Heavy Industrial Direct-Fired Gas

### Models GACDW & GA

Gas-fired air make-up units are complete air supply systems for the ultimate in safety and dependability. These packaged units are available in axial and centrifugal types. The equipment is designed for tempering outside air and supplying it into the building for ventilation make-up and balancing of negative pressure. The units are also adaptable to other applications where ordinary heating or drying operations are involved.

#### Standard Construction

- Heavy-duty industrial Centrifugal DWDI BI BIA or Axial Fans
- Welded 12-gauge steel housing
- Peaked roof to eliminate standing water
- 0 to 92 degree temperature rise
- Dual fuel burner
- Factory assembled and tested
- Remote operating station



## Steam

### Models S, SACS & SADCW

Steam distributing tube coil gives good temperature distribution, maximum freeze protection, and allows the tubes to expand without transmitting stresses to the tubes. Propeller and centrifugal models are available. The centrifugal unit is available with an industrial backward inclined or airfoil wheels. Units come assembled and include fan, coil, vacuum breaker and motorized shutter.

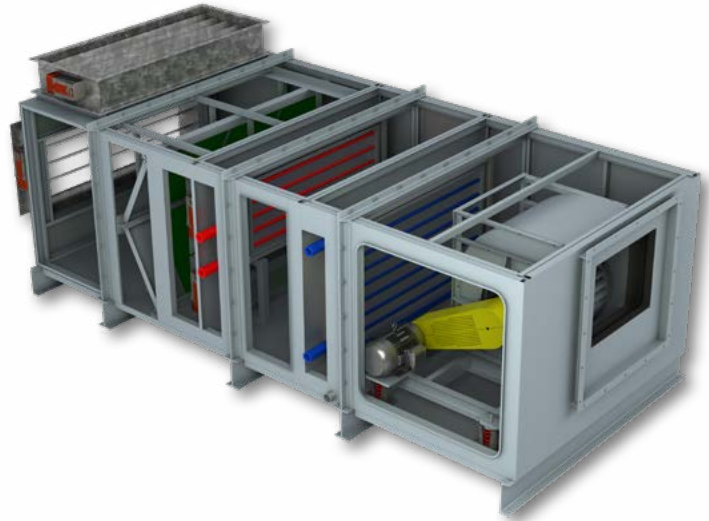

Industrial Backward Inclined Fan



Heavy-Duty Backward Curved Fan

## Gas Door Air Heaters

### Model NDH

Door Air Heaters temper the sudden influx of cold air when an overhead door is open. To mix hot and cold air, it is necessary to create a highly turbulent condition directly in front of the door. The Gas Door Air Heater provides a high velocity blast of hot air to mix with the sudden influx of cold air.

#### Performance

6200 CFM unit has outlet velocity of 3500 FPM.  
4100 CFM unit has outlet velocity of 2300 FPM.



## OFFERING A FULL LINE OF CUSTOM AIR MAKE-UP UNITS:

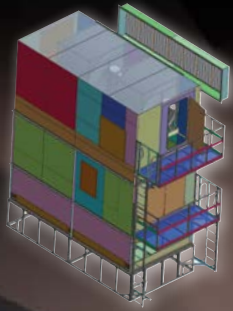

**VERTICAL GAS-FIRED**

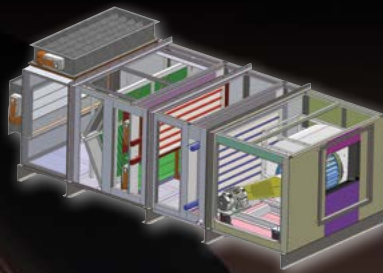

**HOT/CHILLED WATER**

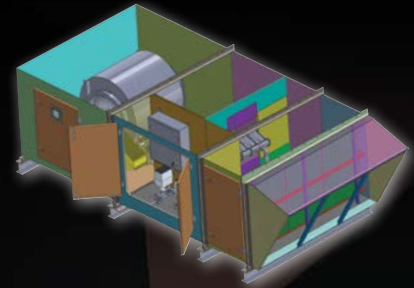

**DIRECT-FIRED GAS HEAT**



**DIRECT DRIVE PROPELLER  
GAS HEAT**

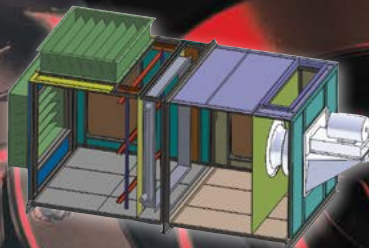

**HIGH TEMPERATURE  
(PLUG FANS)**

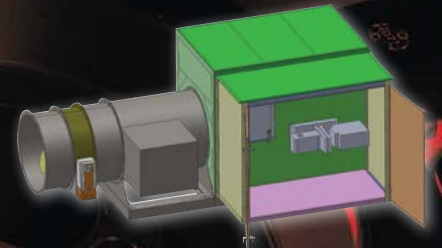

**ELECTRIC HEAT  
AIR MAKE-UP**

**AEROVENT**   
INDUSTRIAL VENTILATION SYSTEMS

**AEROVENT.COM**